

INTERCONNECTS

SERIES 310, 330, 351 • 2,54 GRID (0,46 DIA. PINS), SURFACE MOUNT HEADERS AND SOCKETS • SINGLE ROW STRIPS

Mates with Series 310...023 Surface Mount Z-Bend Socket (See Fig. 3)

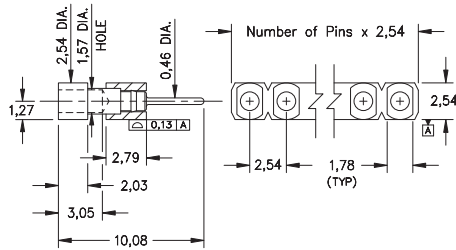

Coplanarity 0,13. For pin counts >10 positions, consult Technical Support.

FIG. 1

Mates with Series 310...023 Surface Mount Z-Bend Socket (See Fig. 3)

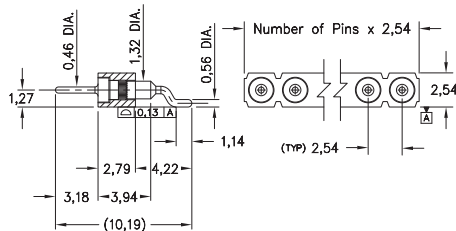

Coplanarity 0,13. For pin counts >10 positions, consult Technical Support.

FIG. 2

Mates with Series 351...002 and 330...027 Surface Mount Header (See Fig. 1 & 2)

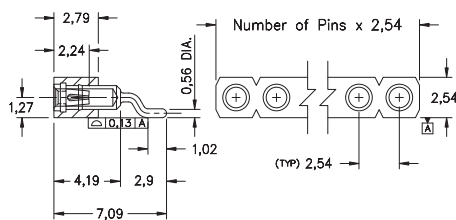

Coplanarity 0,13. For pin counts >10 positions, consult Technical Support.

FIG. 3

- Series 351 horizontal surface mount headers are available with 0,46 dia. pluggable pins (MM #5102). Series 330 horizontal surface mount z-bend headers use MM #3027 pins. See page 224 for details
- Series 310 horizontal surface mount Z-Bend sockets uses MM #1023 receptacles that accept pin diameters from 0,38 - 0,64. See pages 171 for details
- Insulators are high temperature thermoplastic, suitable for all soldering operations
- Ideal for daisy chaining parallel boards

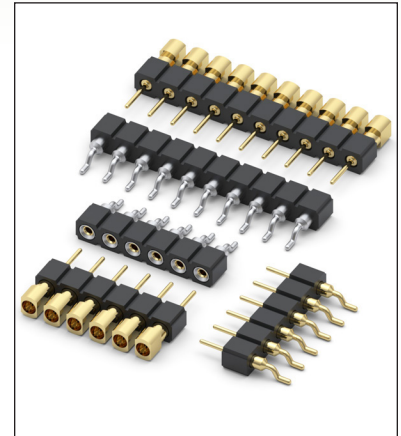

ORDERING INFORMATION

FIG. 1	Series 351...002	0,46 Dia. Surface Mount Header		
		351-10-1	-40-002000	
	Specify number of pins	02-10		
FIG. 2	Series 330...027	0,46 Dia. Surface Mount Z-Bend Header		
		330-XX-1	-40-027000	
	Specify number of pins	02-10		
SPECIFY PLATING CODE XX=		10	40	
Pin Plating		0,25µm Au	5,08µm Sn	

FIG. 3	Series 310...023	0,46 Dia. Surface Mount Z-Bend Socket					
		310-XX-1	-40-023000				
	Specify number of pins	02-10					
SPECIFY PLATING CODE XX=		91	93	99	41	43	44
Sleeve (Pin)		5,08µm Sn/Pb	5,08µm Sn/Pb	5,08µm Sn/Pb	5,08µm Sn	5,08µm Sn	5,08µm Sn
Contact (Clip)		0,25µm Au	0,76µm Au	2,54µm Sn/Pb	0,25µm Au	0,76µm Au	2,54µm Sn

