

DO NOT SCALE FROM THIS PRINT

ALL DIMENSIONS ARE REFERENCE
(SEE T-C114-XXXX-X FOR CONTROLLING PRINT)

DESIGNED & DIMENSIONED
IN MILLIMETERS

TC114-XXXX-X-X

LEAD STYLE
-2830: 28 & 30 AWG

PACKAGING SPECIFICATION
-S: STRIP (15 TERMINALS)
-M: MINI REEL (1K - 5K TERMINALS)
-R: REEL (30K TERMINALS)

PLATING SPECIFICATION
-L: 10µ" LIGHT GOLD IN CONTACT AREA, B.A.T. ON TAIL

CARRIER SPECIFICATIONS

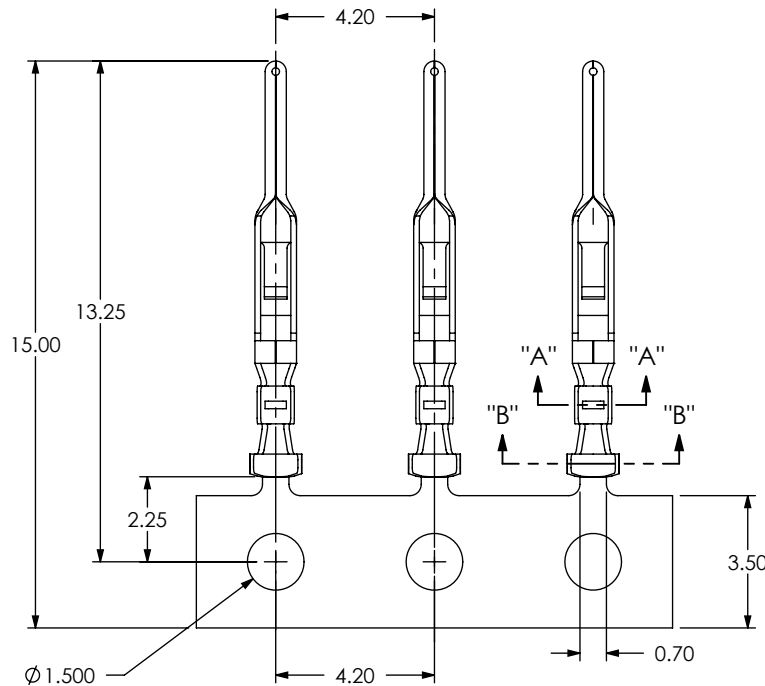
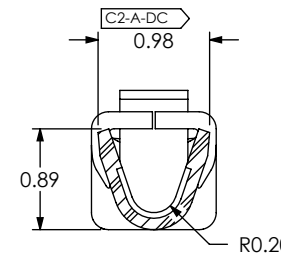
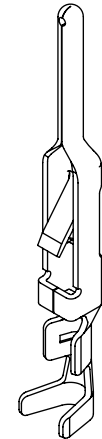
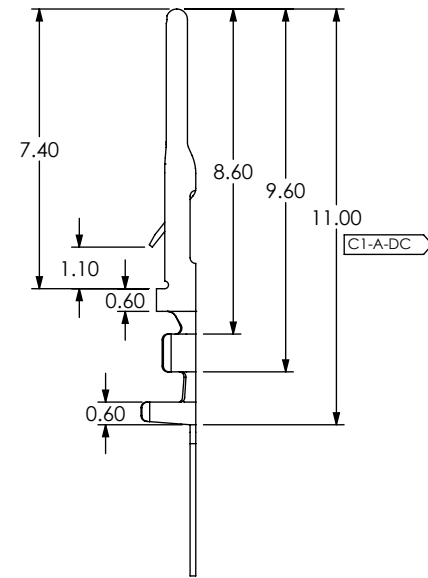
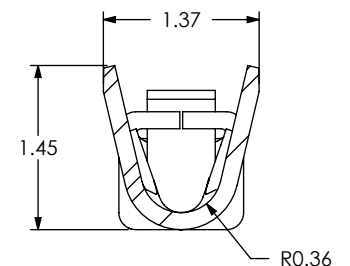

FIG 1
TC114-2830-X-X SHOWN



SECTION "A"- "A"
SCALE 15 : 1



SECTION "B"- "B"
SCALE 15 : 1

NOTES:

1. PLATED T-C114 PARTS TO BE PULLED, PLATING OPTION CONFIRMED, AND
-S (STRIP): 15 ±0 PCS POSITIONED AS SHOWN IN A SAMTEC TUBE.
-M (MINI REEL): 1,000 - 5,000 +300/-0 PCS POSITIONED AS SHOWN ON SAMTEC REEL WITH VIEWPORTS.
-R (REEL): 30,000 +300/-0 PCS POSITIONED AS SHOWN ON SAMTEC REEL WITH VIEWPORTS.
2. LABEL SHOULD INCLUDE PLATING CALLOUT AND BE PLACED ON REEL AS SHOWN, AND PLACE AS SHOWN.
3. MAXIMUM NO OF SPLICES PER REEL:
-M (MINI REEL): 1 SPLICES ARE NOT TO BE CONNECTED. NUMBER OF SPLICES TO BE MARKED ON EACH REEL.
-R (REEL): 2 SPLICES ARE NOT TO BE CONNECTED. NUMBER OF SPLICES TO BE MARKED ON EACH REEL.
4. REELED PARTS TO BE INTERLEAVED WITH PAPER BETWEEN EACH LAYER OF PARTS. ONE SPLICE IN INTERLEAF ALLOWED PER REEL AND TO BE SECURELY CONNECTED.
5. OUTER WRAP SHALL RECEIVE:
-M (MINI REEL): HMS1015C-24MM PROTECTIVE REEL BAND.
-R (REEL): RB-24-1.00-P PROTECTIVE REEL BAND.
6. DUE TO PLATING REQUIREMENTS CONTACT SAMPLES MAY BE REMOVED INTERMITTINGLY FROM THE CARRIER RESULTING IN SMALL GAPS BUT DOES NOT AFFECT FINAL PIN COUNT.

| | | |
|--|--|---|
| <p>UNLESS OTHERWISE SPECIFIED, DIMENSIONS ARE IN MILLIMETERS. TOLERANCES ARE: DECIMALS ANGLES</p> | <p>PROPRIETARY NOTE THIS DOCUMENT CONTAINS INFORMATION CONFIDENTIAL AND PROPRIETARY TO SAMTEC, INC. AND SHALL NOT BE REPRODUCED OR TRANSFERRED TO OTHER DOCUMENTS OR DISCLOSED TO OTHERS OR USED FOR ANY PURPOSE OTHER THAN THAT WHICH IT WAS OBTAINED WITHOUT THE EXPRESSED WRITTEN CONSENT OF SAMTEC, INC.</p> | <p>samtec 520 PARK EAST BLVD., NEW ALBANY, IN 47150 PHONE: 812-944-6733 FAX: 812-948-5047 e-Mail: info@SAMTEC.com code 55322</p> |
| <p>MATERIAL: DO NOT SCALE DRAWING SHEET SCALE: 6:1</p> | <p>DESCRIPTION: ACCLIMATE DISCRETE WIRE TERMINAL</p> | |
| <p>PHOS BRONZE THICKNESS: 0.15±0.01</p> | <p>DWG. NO. TC114-XXXX-X-X</p> | |
| <p>F:\dwg\sw\exisprod\compnt\terminal\TC114-XXXX-X-X.SLDDRW</p> | | <p>BY: TRAVIS N 11/26/2013 SHEET 1 OF 2</p> |

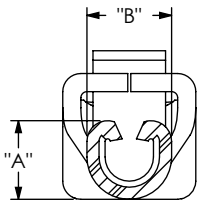

WIRE CRIMP
SCALE 16:1



INSULATION STRIP LENGTH

| TABLE 1 | | | | | | |
|---------------|-----|-------------|-------------------------------|----------------|----------------|----------------|
| P/N | AWG | STRANDS/AWG | INSULATION OD | "A" | "B" | "C" |
| T-C114-2830-X | 30 | 7/38 | 0.737[.0290]- 0.940[.0370] | 0.406 [0.0160] | 0.813 [0.0320] | 1.905 [0.0750] |
| | 28 | 7/36 | | 0.457 [0.0180] | 0.813 [0.0320] | |

FIG 2
RECOMMENDED PROCESSING

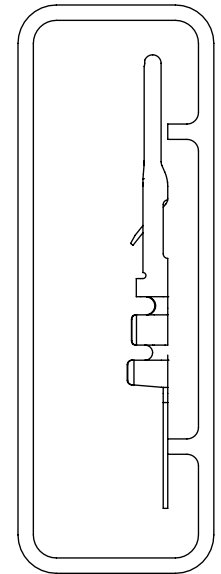

TUBE: PT-CC001
PLUG: TP-03

SCALE 4:1

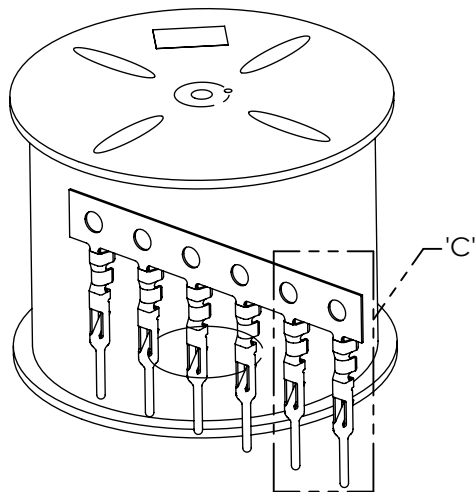

SCALE 2:1

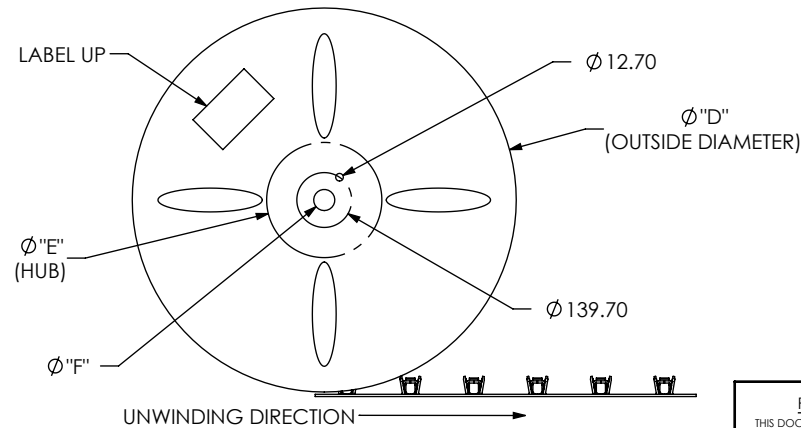
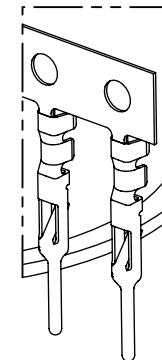

FIG 3
REEL SPECIFICATIONS



DETAIL 'C'
SCALE 3:1

PROPRIETARY NOTE
THIS DOCUMENT CONTAINS INFORMATION
CONFIDENTIAL AND PROPRIETARY TO
SAMTEC, INC. AND SHALL NOT BE REPRODUCED
OR TRANSFERRED TO OTHER DOCUMENTS OR
DISCLOSED TO OTHERS OR USED FOR ANY
PURPOSE OTHER THAN THAT WHICH IT WAS
OBTAINED WITHOUT THE EXPRESSED WRITTEN
CONSENT OF SAMTEC, INC.

DO NOT SCALE DRAWING

SHEET SCALE: 5:1



520 PARK EAST BLVD, NEW ALBANY, IN 47150
PHONE: 812-944-6733 FAX: 812-948-5047
e-Mail info@SAMTEC.com code 55322

DESCRIPTION:
ACCLIMATE DISCRETE WIRE TERMINAL

DWG. NO.
TC114-XXXX-X-X

BY: TRAVIS N 11/26/2013 SHEET 2 OF 2

| TABLE 2 | | | | |
|----------|-------------------|--------|-------|-------|
| SUPPLIED | REEL PART NUMBER | "D" | "E" | "F" |
| -R | R-24-08.00-1.00-P | 609.60 | 203.2 | 28.58 |
| -M | MR-13.0-4.00-24 | 330.20 | 101.6 | 12.70 |