

Cable lug - C-PCEI 2,5/2 - 3241216

Please be informed that the data shown in this PDF Document is generated from our Online Catalog. Please find the complete data in the user's documentation. Our General Terms of Use for Downloads are valid (<http://phoenixcontact.com/download>)



Pin cable lug, blue, 1.5 - 2.5 mm², L1 = 12 mm, with copper sleeve incorporated, for insulation crimp

Why buy this product

- Electrolytic tin plating
- The mechanical load capacity of the connection is significantly increased by the additionally applied copper sleeve (insulation crimp).
- Halogen-free
- 'EASY ENTRY' for easy and reliable conductor entry

Key Commercial Data

| | |
|--------------|---|
| Packing unit | 100 STK |
| GTIN |  4 046356 826211 |
| GTIN | 4046356826211 |

Technical data

Dimensions

| | |
|--|---------|
| Length (b) | 23.5 mm |
| Length contact range | 10.5 mm |
| Length of insulation sleeve (c) | 11 mm |
| Inner dimension of the insulating collar (d) | 4.5 mm |
| Inner diameter (f) | 1.9 mm |
| Material thickness (g) | 0.8 mm |

Ambient conditions

| | |
|---------------------------------|-------------------|
| Ambient temperature (operation) | -20 °C ... 105 °C |
|---------------------------------|-------------------|

General

| | |
|------------|--------------|
| Color | blue |
| Components | halogen-free |

Cable lug - C-PCEI 2,5/2 - 3241216

Technical data

General

| | |
|--|------------|
| Flammability rating according to UL 94 | V2 |
| Material | Copper |
| Insulating material | PA |
| Coating | tin-plated |

Standards and Regulations

| | |
|--|----|
| Flammability rating according to UL 94 | V2 |
|--|----|

Environmental Product Compliance

| | |
|------------|---|
| China RoHS | Environmentally friendly use period: unlimited = EFUP-e |
| | No hazardous substances above threshold values |

Drawings

Dimensional drawing

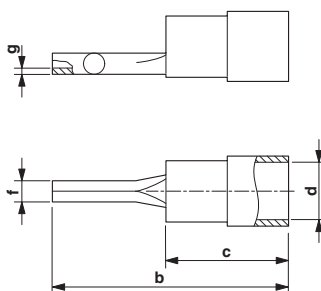

Approvals

Approvals

Approvals

EAC

Ex Approvals

Approval details

| | | |
|-----|--|---------------|
| EAC | | EAC-Zulassung |
|-----|--|---------------|

Phoenix Contact 2018 © - all rights reserved
<http://www.phoenixcontact.com>

PHOENIX CONTACT GmbH & Co. KG
Flachmarktstr. 8
32825 Blomberg
Germany
Tel. +49 5235 300
Fax +49 5235 3 41200
<http://www.phoenixcontact.com>