

| REV | DATE | BY | CHK | APP | DESCRIPTION | DATE | APP |
|-----|----------------|--------|-----|-----|-------------|--------|-------------|
| B | 11/16/94 | UN | CAJ | TEH | EUN | AU5477 | - |
| C | 10/13/93 | T.S. | | | | | 6-2989 JW |
| D | 10/13/93 | T.S. | | | | | 24194 JS |
| E | 11/16/94 | N.F.S. | | | | | |
| F | 05/03-05/22-97 | T.S. | | | | | 9-22-97 JW |
| G | 04/18-01/99 | O-I | | | | | 4 NOV 01 WM |
| H | 05/12-04/64-02 | | | | | | 05-0001 WM |

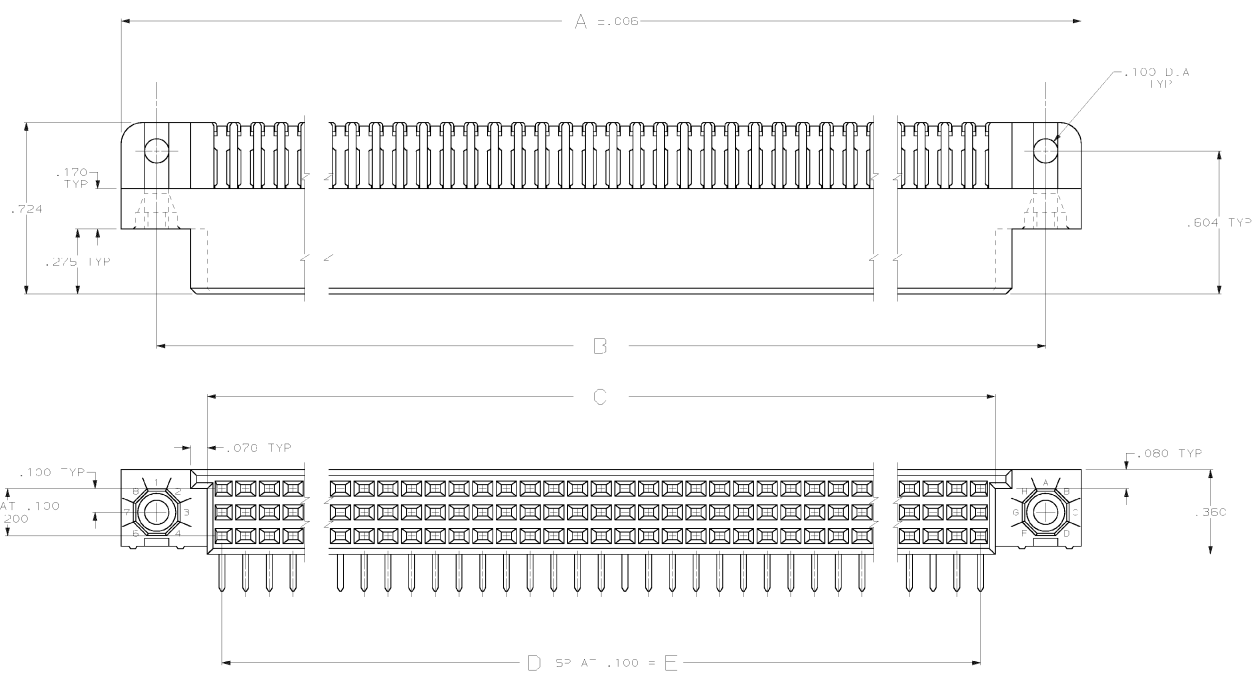

- △ HOUSING MATERIAL: THERMOPLASTIC, BLACK.
- △ CONTACT MATERIAL: BERYLLIUM COPPER.
- △ CONTACT FINISH: .000050-.000100 NICKEL UNDERPLATE ALL OVER WITH .000030 GOLD IN CONTACT AREA AND .000100-.000200 TIN-LEAD PLATED POSTS.

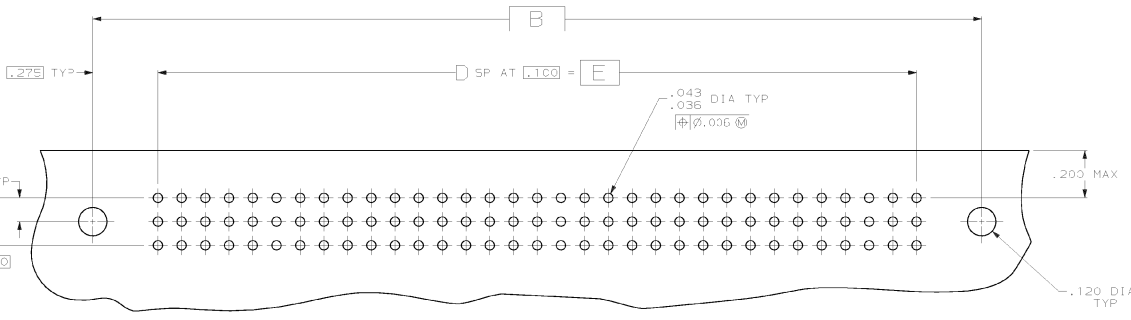
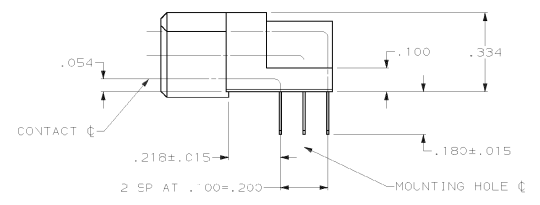

| | | | | | | | |
|----------|-------|----|-------|-------|-------|-----|----------|
| OBsolete | 7.900 | 79 | 8.02± | 8.450 | 8.750 | 240 | 534044-8 |
| OBsolete | 7.400 | 74 | 7.52± | 7.950 | 8.350 | 225 | 534044-2 |
| OBsolete | 6.900 | 69 | 7.02± | 7.450 | 7.750 | 210 | 534044-6 |
| OBsolete | 5.400 | 54 | 5.52± | 5.950 | 6.250 | 165 | 534044-5 |
| OBsolete | 4.900 | 49 | 5.02± | 5.450 | 5.750 | 150 | 534044-4 |
| OBsolete | 3.900 | 39 | 4.02± | 4.450 | 4.750 | 120 | 534044-3 |
| OBsolete | 3.100 | 31 | 3.22± | 3.650 | 3.950 | 96 | 534044-2 |
| OBsolete | 2.900 | 29 | 3.02± | 3.450 | 3.750 | 90 | 534044-1 |

| | E | D | C | B | A | NO OF POSN | PART NUMBER |
|---|-----------|--|---|--------|---|------------|-------------|
| DO NOT SCALE PRINT. UNLESS SPECIFIED DIMENSIONS IN INCHES TOLERANCES ON 1/2 FLD DEC ± .005 ANGLES | | | | | | | |
| DR 6-17-R1 J GALLUCCI B6 CHK 12/10/91 DAVID HOFMAN | | | | | | | |
| AMPD 12/16/91 VAN WEBSTER | | | | | | | |
| PRODUCT SPEC 108-1099 | | | | | | | |
| FINISH - | | | | | | | |
| APPLICATOR SPEC - | | | | | | | |
| HEIGHT | | | | | | | |
| AMP | | AMP Incorporated Harrisburg, PA 17105-3606 | | | | | |
| NAME | | ASSEMBLY, RECEPTACLE, TWIN BEAM CONNECTOR, 3 ROW, 2 MOUNTING HOLES, .180 POST LENGTH | | | | | |
| SIZE | CAGE CODE | DRAWING NO | | | | | |
| D | 00779 | 534044 | | | | | |
| SCALE | 4:1 | SHEET | | 1 OF 1 | | | |