

THIS DRAWING IS A CONTROLLED DOCUMENT.

| PART NUMBER | REV | FIRST USED |
|-------------|-----|------------|
| 680621-1 | B | 122500-1 |
| 680621-2 | B | 565435-5 |
| 680621-3 | B | 354500-1 |

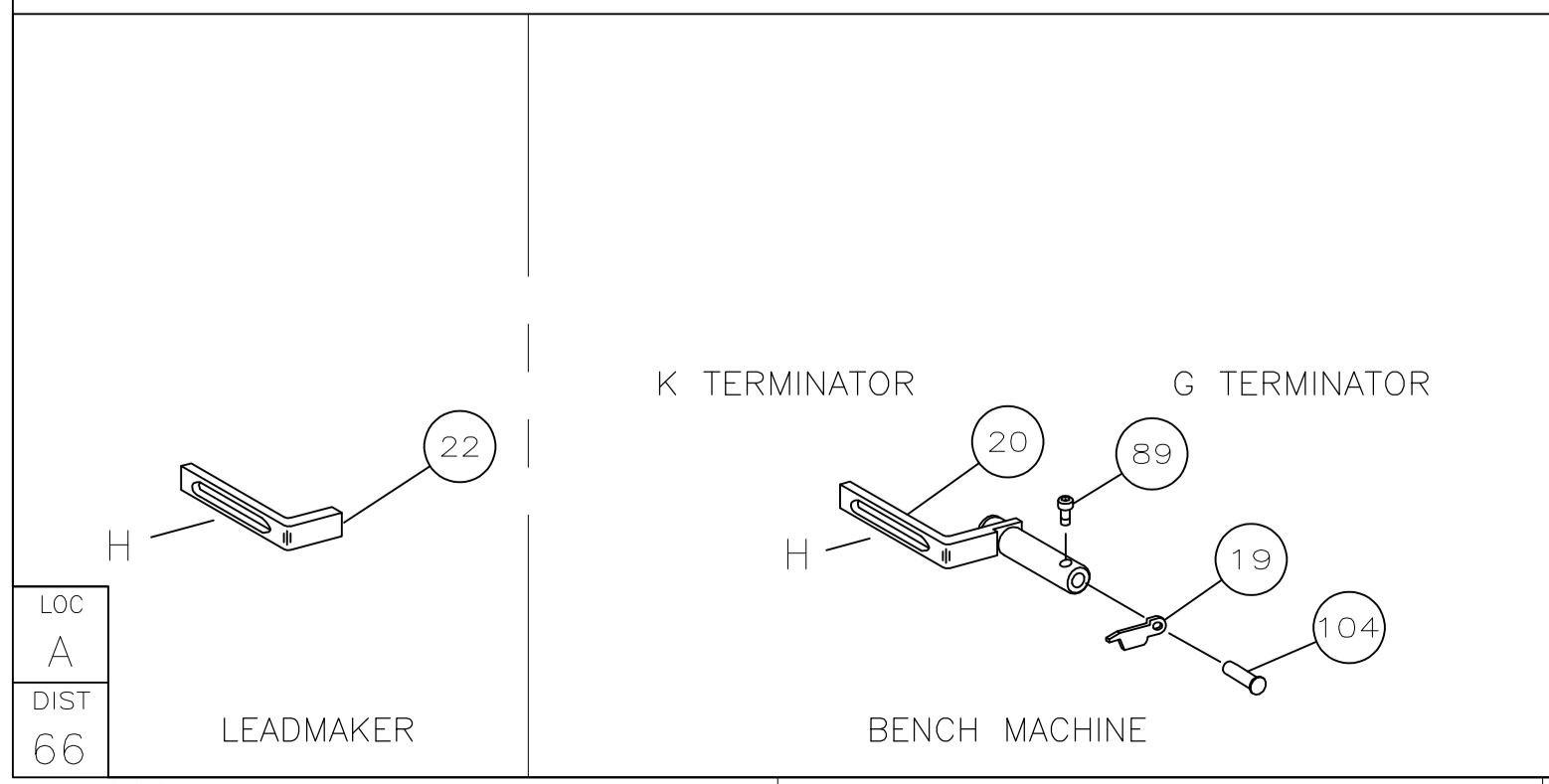
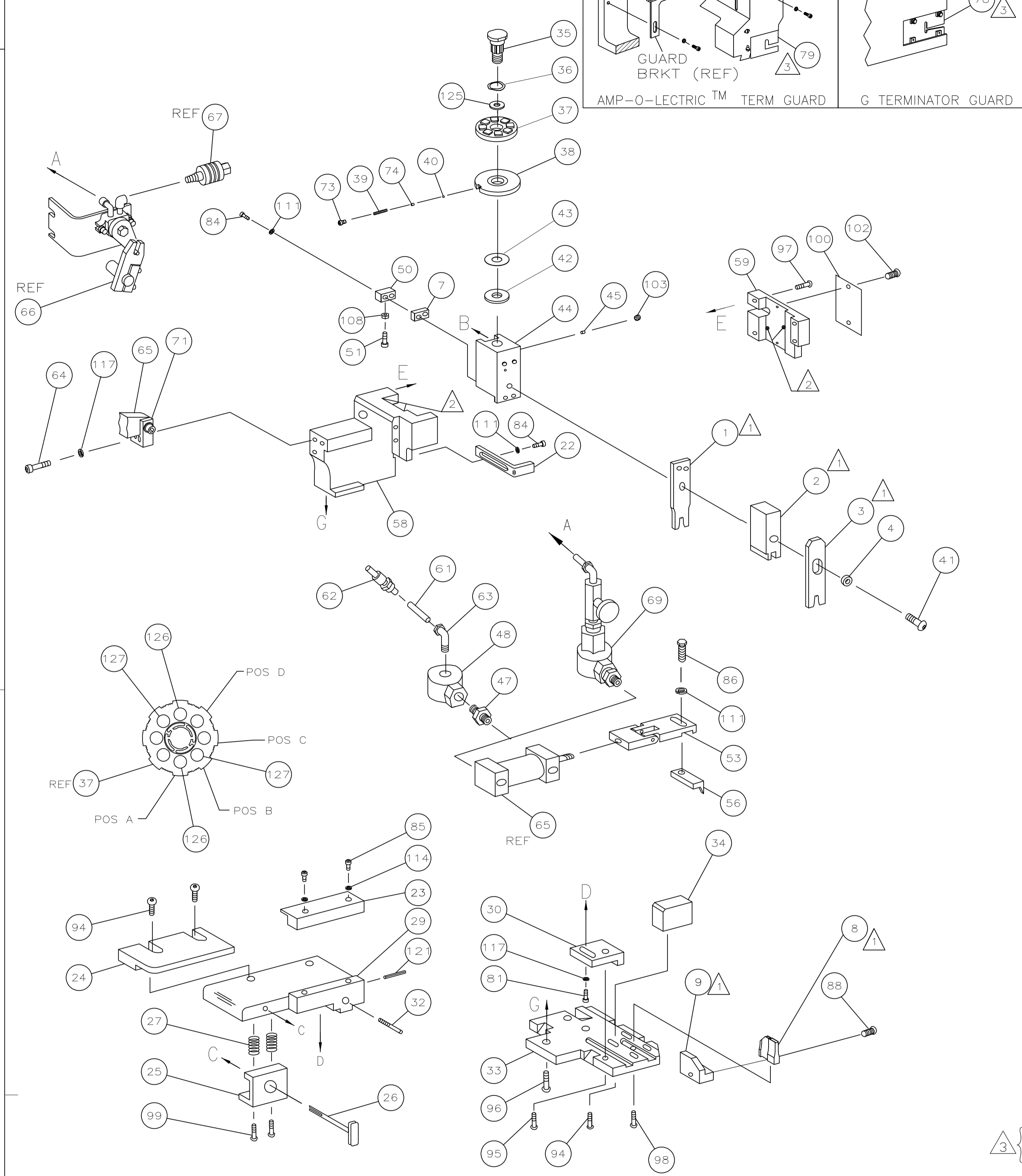

- 1 RECOMMENDED SPARE PARTS.
- 2 GREASE LIGHTLY.
- 3 GUARD MUST BE IN PLACE WHEN OPERATING APPLICATOR IN A BENCH MACHINE.
- 4 SEE DRAWING FOR COMPONENTS
- 5 INSULATION RANGE TO BE DETERMINED AT SET UP.

| AMP | | MFR | | CRIMP DATA (NON-AMP TERMINAL-CUST SPEC) | |
|-------------------|----------------|----------|------------------|---|--------------------------|
| 286710 | | 12160636 | | PAD LTR | CRIMP HEIGHT |
| 286712 | | 12110646 | | | WIRE SIZE |
| | | | | A | .083 ±.002 [2.10 ±.05mm] |
| | | | | B | .071 ±.002 [1.80 ±.05mm] |
| | | | | C | NOT USED |
| | | | | D | NOT USED |
| | | | | CRIMP SIZE | TYPE RANGE |
| | | | | WIRE | .120 [3.05mm] F 14-12 |
| | | | | INSUL | .180 [4.57mm] F 5 |
| WIRE STRIP LENGTH | TERM APPL SPEC | FEED | APPL INSTRUCTION | SET UP GAGE | LAYOUT |
| .281-.312 | NONE | .590 | 408-8040 | 458637-1 | L2098 |

| QTY | REQD | PER | ASSY | PART NO | DESCRIPTION | ITEM NO |
|-----|------|-----|------|------------|---------------------------------|---------|
| 2 | 2 | 2 | - | 8-354778-7 | PIN, WIRE DISC (.2930)B | 127 |
| 2 | 2 | 2 | - | 6-354778-3 | PIN, WIRE DISC (.2810)A | 126 |
| 1 | 1 | 1 | - | 986950-1 | WASHER, FLAT PRECISION | 125 |
| 1 | 1 | 1 | - | 217238-1 | GENERAL INSTRUCTION PACKAGE | 124 |
| 1 | 1 | 1 | - | 4088040 | SF APPL INST 408-8040 | 123 |
| 1 | 1 | 1 | - | 4-21028-0 | PIN,SLT SPR(Ø.093x.75)ST GDE PL | 121 |
| 3 | 3 | 3 | - | 21024-5 | WASHER, LOCK(#10)ADJ BLOCK | 117 |
| 2 | 2 | 2 | - | 21024-2 | WASHER,LOCK(#4)FRONT STP GUIDE | 114 |
| 4 | 4 | 4 | - | 21024-4 | WASHER,LOCK(#8)STRIPPER | 111 |
| 1 | 1 | 1 | - | 21018-5 | NUT,HEX(NO.6)HOLDDOWN | 108 |
| 1 | 1 | - | - | 992031-1 | PIN, CLEVIS | 104 |
| 1 | 1 | 1 | - | 21009-2 | SCR,SKT SET(1/4-20x.25 LW)RAM | 103 |
| 2 | 2 | 2 | - | 21017-2 | SCR,DRIVE(#2x.19)ID PLATE | 102 |
| 1 | 1 | 1 | - | 461264-1 | PLATE, IDENTIFICATION | 100 |
| 2 | 2 | 2 | - | 3-21002-0 | SCR,BHC(10-32x.88)DRAG | 99 |
| 1 | 1 | 1 | - | 22733-8 | SCR,BHC(8-32x.38 LW)ANVIL | 98 |
| 4 | 4 | 4 | - | 2-21002-9 | SCR,BHC(10-32x.75)CAP | 97 |
| 3 | 3 | 3 | - | 2-22733-8 | SCR,BHC(1/4-20x.62)HSG | 96 |
| 1 | 1 | 1 | - | 2-21002-7 | SCR,BHC(10-32x.50)SG ADJ BLK | 95 |
| 4 | 4 | 4 | - | 2-21002-2 | SCR,BHC(8-32x.50)TERM H DWN | 94 |
| 1 | 1 | - | - | 7-21000-9 | SCR,SHC(4-40x.19)STRIPPER | 89 |
| 1 | 1 | 1 | - | 3-21000-0 | SCR,HEX HD(8-32x.88)SHEAR | 88 |
| 2 | 2 | 2 | - | 2-21000-8 | SCR,HEX HD(8-32x.62)SHEAR | 87 |
| 1 | 1 | 1 | - | 2-22603-1 | SCR,HEX HD(8-32x.38)FEED FINGER | 86 |
| 2 | 2 | 2 | - | 1-21000-5 | SCR,SHC(4-40x.25)F ST GUIDE | 85 |
| 3 | 3 | 3 | - | 2-21000-7 | SCR,SHC(8-32x.50)STRIPPER | 84 |
| 1 | 1 | 1 | - | 3-21000-4 | SCR,SHC(10-32x.38)SG ADJ BL | 81 |
| - | 1 | - | - | 462992-7 | GUARD ASSY | 79 |
| REF | - | - | - | 679532-1 | INSERT, GUARD | 78 |
| 1 | 1 | 1 | - | 690603-1 | SPRING, ASSIST | 74 |
| 1 | 1 | 1 | - | 23030-1 | SCR,SHC(6-32x.25 SL)INS DISC | 73 |
| 1 | 1 | 1 | - | 459610-3 | MOUNT, FEED BRACKET | 71 |
| -3 | -2 | -1 | U/M | PART NO | DESCRIPTION | ITEM NO |

| QTY | REQD | PER | ASSY | PART NO | DESCRIPTION | ITEM NO |
|-------|------|-------|------|------------|-------------------------------|---------|
| 4 | - | 1 | - | 692655-5 | AIR FEED VALVE ASSY | 70 |
| - | REF | - | - | 24042-2 | VALVE, SHUT OFF | 67 |
| - | REF | - | - | 692655-6 | AIR FEED VALVE ASSY | 66 |
| 1 | 1 | 1 | - | 461065-1 | AIR FEED ASSY (1 INCH) | 65 |
| 2 | 2 | 2 | - | 3-21000-7 | SCR,SHC(10-32x.75)AIR ASSY | 64 |
| 1 | - | 1 | - | 980285-2 | ELBOW, SWIVEL 1/8 NPT - 1/4 T | 63 |
| 1 | - | 1 | - | 23238-1 | QUICK DISCONNECT | 62 |
| 21.00 | - | 21.00 | IN | 27319-4 | TUBING, POLY-FLO Ø.25 | 61 |
| 1 | 1 | 1 | - | 454220-1 | CAP, RAM | 59 |
| 1 | 1 | 1 | - | 454485-1 | HOUSING | 58 |
| 1 | 1 | 1 | - | 3-694433-2 | PAWL, FEED | 56 |
| 1 | 1 | 1 | - | 461062-1 | FEED FINGER ASSY | 53 |
| 1 | 1 | 1 | - | 811242-2 | BUMPER, HOLDDOWN | 51 |
| 1 | 1 | 1 | - | 690753-1 | SPACER, TONKER | 50 |
| 1 | - | 1 | - | 22374-7 | VALVE, QUICK EXHAUST | 48 |
| 1 | - | 1 | - | 22304-1 | NIPPLE, HEX 1/8 NPT | 47 |
| 1 | 1 | 1 | - | 690191-1 | PLUG, NYLON | 45 |
| 1 | 1 | 1 | - | 819307-6 | RAM | 44 |
| 1 | 1 | 1 | - | 690125-1 | WASHER, LAMINATED | 43 |
| 1 | 1 | 1 | - | 690124-1 | WASHER, RAM | 42 |
| 1 | 1 | 1 | - | 690686-2 | BOLT, CRIMPER(5/16x1.00) | 41 |
| 1 | 1 | 1 | - | 23241-6 | BALL, STEEL | 40 |
| 1 | 1 | 1 | - | 690170-1 | SPRING, COMPRESSION | 39 |
| 1 | 1 | 1 | - | 690142-1 | DISC, INSULATION | 38 |
| 1 | 1 | 1 | - | 354777-1 | WIRE DISC, PLASTIC | 37 |
| 1 | 1 | 1 | - | 22480-5 | WASHER, SPRING | 36 |
| 1 | 1 | 1 | - | 690212-1 | POST, RAM | 35 |
| 1 | 1 | 1 | - | 690786-1 | SUPPORT, TERMINAL | 34 |
| 1 | 1 | 1 | - | 455675-1 | PLATE, BASE | 33 |
| 1 | 1 | 1 | - | 690432-3 | SCREW, ADJUSTMENT | 32 |
| 1 | 1 | 1 | - | 455689-1 | BLOCK, STRIP GUIDE ADJ | 30 |
| 1 | 1 | 1 | - | 5-455671-2 | PLATE, STRIP GUIDE | 29 |
| 2 | 2 | 2 | - | 1-22284-0 | SPRING, DRAG | 27 |
| 1 | 1 | 1 | - | 690546-1 | LEVER, DRAG RELEASE | 26 |
| 1 | 1 | 1 | - | 690754-7 | DRAG, TERMINAL | 25 |
| 1 | 1 | 1 | - | 1-690440-9 | GUIDE, STRIP (REAR) | 24 |
| 1 | 1 | 1 | - | 690712-9 | GUIDE, STRIP (FRONT) | 23 |
| - | - | 1 | - | 690472-2 | STRIPPER | 22 |
| 1 | 1 | - | - | 679218-1 | STRIPPER WIRE STOP ASSY | 20 |
| 1 | 1 | - | - | 458949-2 | STRIPPER | 19 |
| 1 | 1 | 1 | - | 853714-5 | PLATE, REAR SHEAR | 9 |
| 1 | 1 | 1 | - | 1214596-3 | ANVIL | 8 |
| 1 | 1 | 1 | - | 1-240641-9 | SPACER, DEPRESSOR (REAR) | 7 |
| 1 | 1 | 1 | - | 238009-1 | SPACER, BLOCK CRIMPER | 4 |
| 1 | 1 | 1 | - | 4-456134-6 | CRIMPER, INSULATION | 3 |
| 1 | 1 | 1 | - | 853720-5 | BLADE,SLUG | 2 |
| 1 | 1 | 1 | - | 6-458141-8 | CRIMPER, WIRE | 1 |
| -3 | -2 | -1 | U/M | PART NO | DESCRIPTION | ITEM NO |

CUSTOMER ACCESSIBLE PRODUCTION DRAWING