

THIS DRAWING IS UNPUBLISHED. RELEASED FOR PUBLICATION
 © COPYRIGHT - By - ALL RIGHTS RESERVED.

LOC		DIST		REVISIONS			
P	LTR	DESCRIPTION	DATE	DWN	APVD		
		L2	REVISED PER ECO-11-005030	11MAR11	RK	HMR	

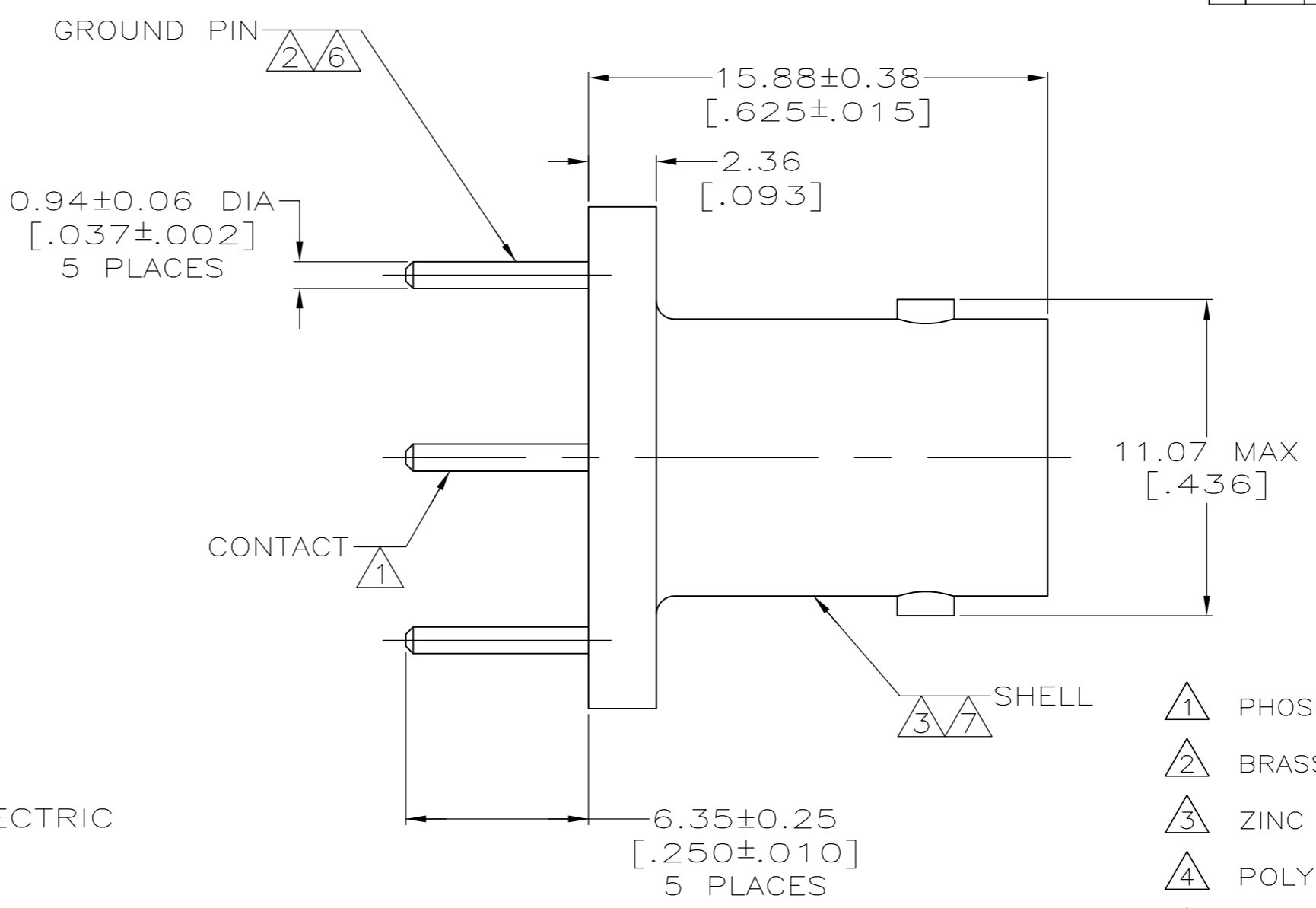

- ① PHOSPHOR BRONZE PER QQ-B-750.
- ② BRASS PER QQ-B-626.
- ③ ZINC PER QQ-Z-363.
- ④ POLYESTER, PBT, PER MIL-M-24519.
- ⑤ SILVER PLATE PER QQ-S-365
2.54 μm [.000100] MINIMUM THICK.
- ⑥ TIN PLATE PER ASTM-B-545
2.54 μm [.000100] MINIMUM THICK.
- ⑦ NICKEL PLATE PER QQ-N-290
3.81 μm [.000150] MINIMUM THICK.
- ⑧ GOLD PLATE PER MIL-G-45204,
0.76 μm [.000030] MINIMUM THICK.
- 9. SEE INSTRUCTION SHEET 408-9889.

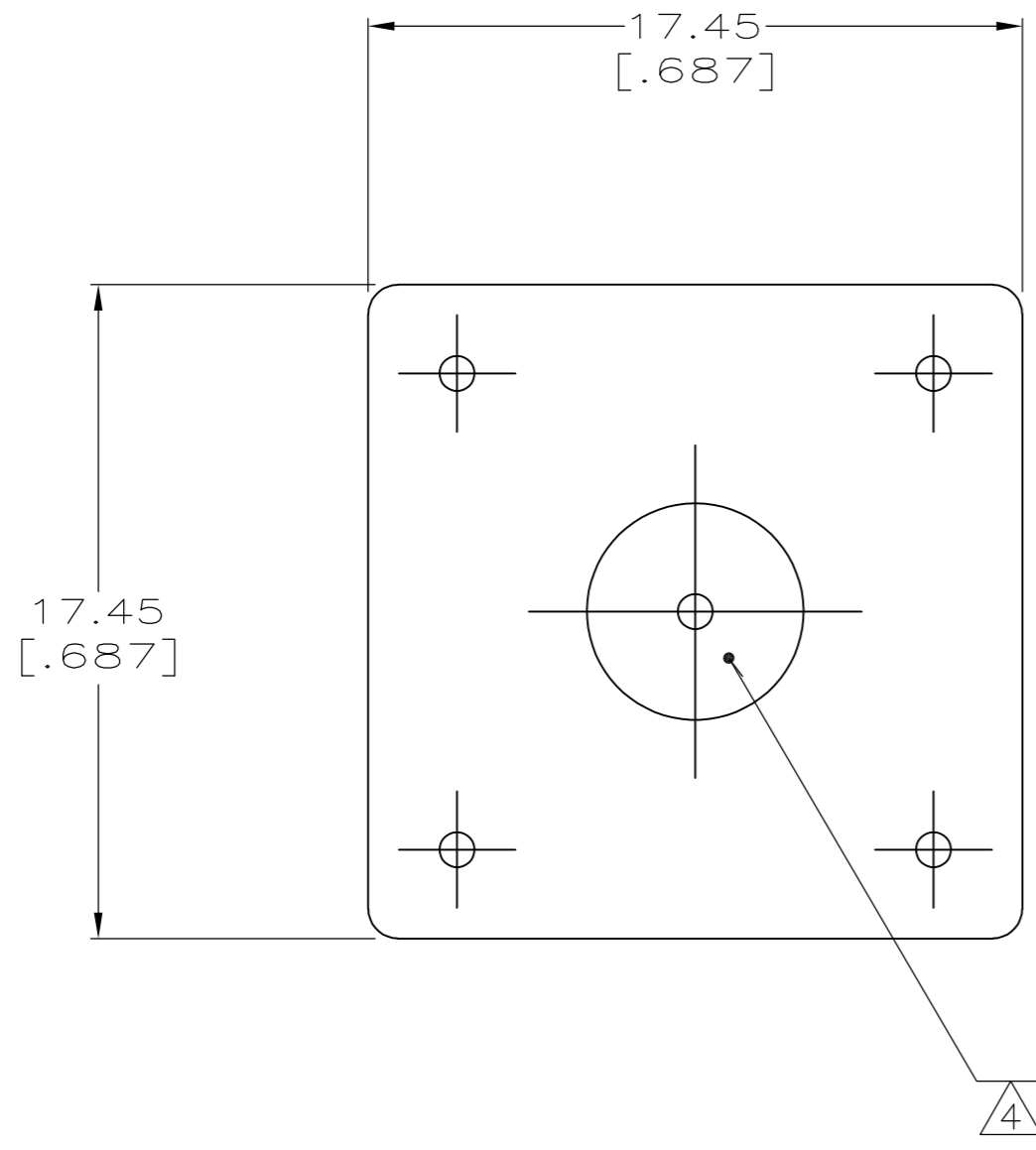
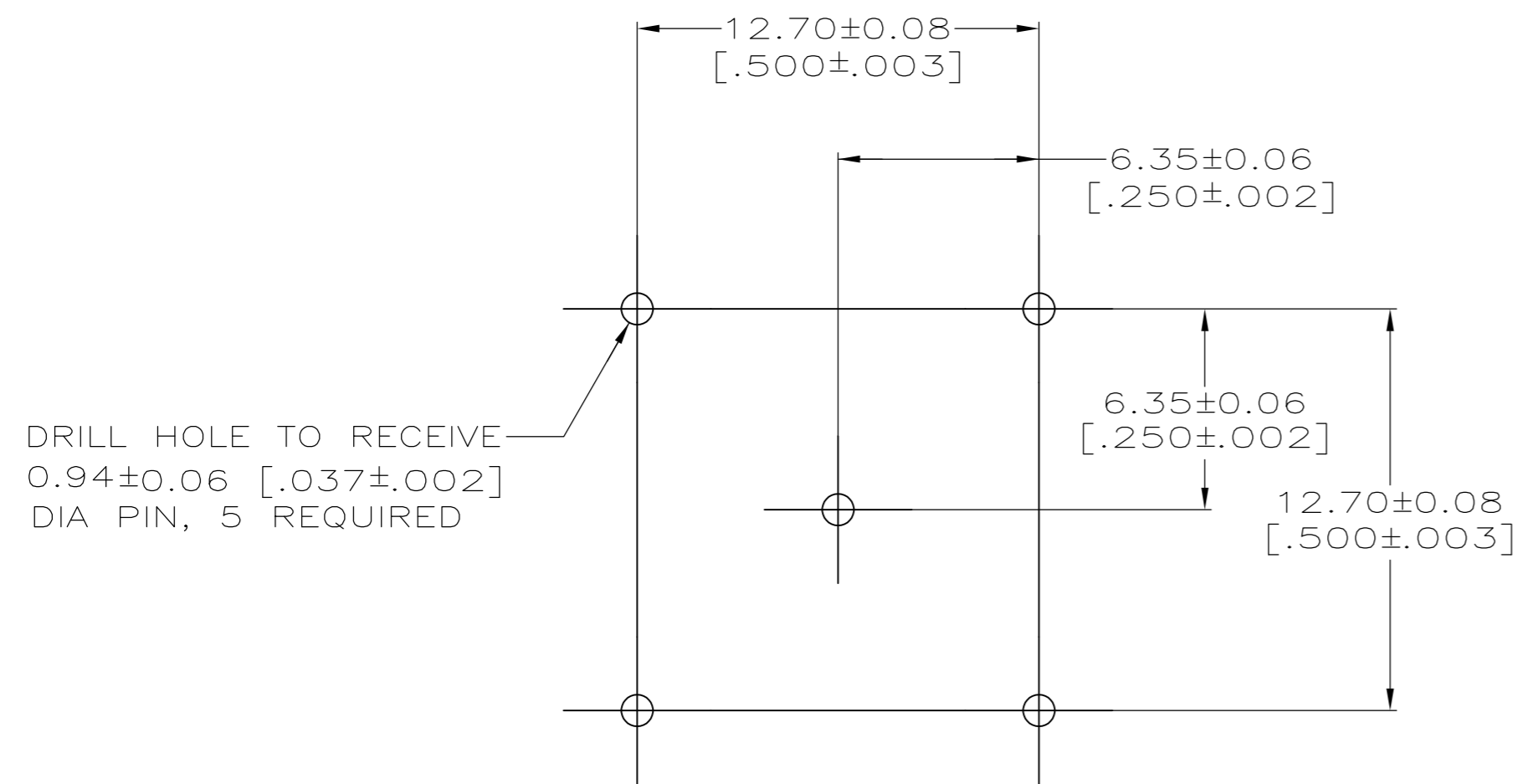

SUGGESTED PCB CONFIGURATION

OBSOLETE	⑥	9-227699-0
	⑧	227699-3
	⑧	227699-2
	⑤	227699-1
	CONTACT FINISH	PART NUMBER

THIS DRAWING IS A CONTROLLED DOCUMENT.		DWN	J. LIPPERT	2-14-92	 TE Connectivity							
DIMENSIONS: INCHES		CHK	A. GABANY	2-14-92								
TOLERANCES UNLESS OTHERWISE SPECIFIED:		APVD	J. LIPPERT	02-14-92								
0 PLC ± - 1 PLC ± - 2 PLC ± 0.20 [.008] 3 PLC ± - 4 PLC ± - ANGLES ± -		PRODUCT SPEC	108-12078									
MATERIAL		FINISH	WEIGHT -		SIZE	A2	CAGE CODE	00779	DRAWING NO	C=227699	RESTRICTED TO	-
①②③④		⑤⑥⑦⑧⑨⑩		CUSTOMER DRAWING		SCALE	5:1	SHEET	1 of 1	REV	L2	