

SUPERCEDED BY  
CUSTOMER PRINT  
1059506

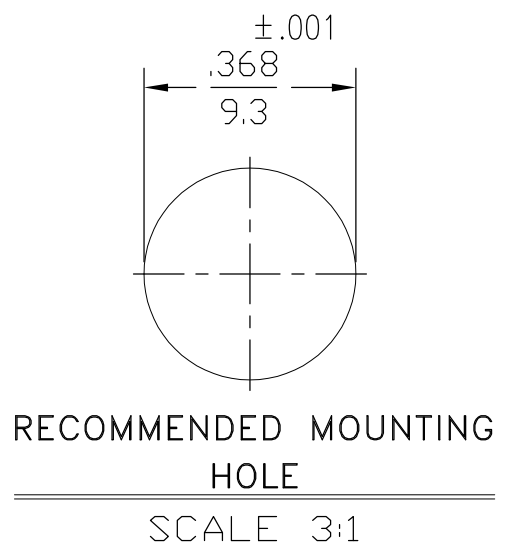

DESIGNED FOR USE WITH .085 S.R.	
CABLE ENTRY DIAMETER MINIMUM	
HOUSING	.089
CONTACT	.0214

REVISIONS			
REV	DESCRIPTION	DATE	APPROVED
A1	REVISED PER ECO 08-020996	12/16/2008	JO

NOTES:

1. CAPTURED CENTER CONTACT

.XXX = in  
XX.X = mm (REF)

COMPONENT	MATERIAL	FINISH
HOUSING, OUTER MOUNTING NUT WASHER	STAINLESS STEEL PER ASTM-A484 AND ASTM- A582, TYPE 303	PASSIVATE PER QQ-P-35
RETAINING RING	STAINLESS STEEL	PASSIVATE PER QQ-P-35
HOUSING, INNER	STAINLESS STEEL PER ASTM-A484 AND ASTM- A582, TYPE 303	GOLD PLATE PER MIL-G-45204
DIELECTRIC	TFE FLUOROCARBON PER ASTM-D-1457	N/A
CENTER CONTACT	BERYLLIUM COPPER PER ASTM-B-196 OR ASTM-B-197, ALLOY C17300, CONDITION H	GOLD PLATE PER MIL-G-45204
CONTACT SLEEVE	BERYLLIUM COPPER PER ASTM-B-196, ALLOY C17300, CONDITION H	GOLD PLATE PER MIL-G-45204
CONTACT RING	BERYLLIUM COPPER PER ASTM-B-194, ALLOY C17200, CONDITION H	GOLD PLATE PER MIL-G-45204
LOCKWASHER	CARBON STEEL 1050	NICKEL PLATE PER QQ-N-290
SPRING	MUSIC WIRE	NICKEL PLATE PER QQ-N-290

UNLESS OTHERWISE SPECIFIED  
DIMENSIONS ARE IN INCHES

FRAC.	DEC.	ANGLES
± 1/64	±.005	± 1'

These drawings and speci-  
fications are the property of  
M/A CDM Interconnect Div.  
and shall not be reproduced  
or copied or used in whole  
or in part as the basis for  
the manufacture or sale o  
f item(s) without written  
permission.

DRAWN BY J.B.	DATE 9/10/87
CHECKED BY M.H/M.	9/16/87
APP'D BY B.A.R.	9/16/87

**AMP** Incorporated  
140 Fourth Avenue  
Waltham, MA 02451-7599

USE ASS'Y PROCEDURE  
408-04596  
(45-047)  
NO. A.P. \_\_\_\_\_

TITLE OSP FLOATING PANEL FEEDTHRU CABLE JACK DIRECT SOLDER ATTACHMENT			
SIZE B	CODE IDENT NO. 26805	4522-7985-02	REV A1
SCALE 6:1			SHEET 1 OF 1