

REV.	DATE	DESCRIPTION
NC	04/11/02	INITIAL RELEASE
A	12/11/07	REVISE CONTACT PIN MATERIAL / UPDATE DRAWING FORMAT

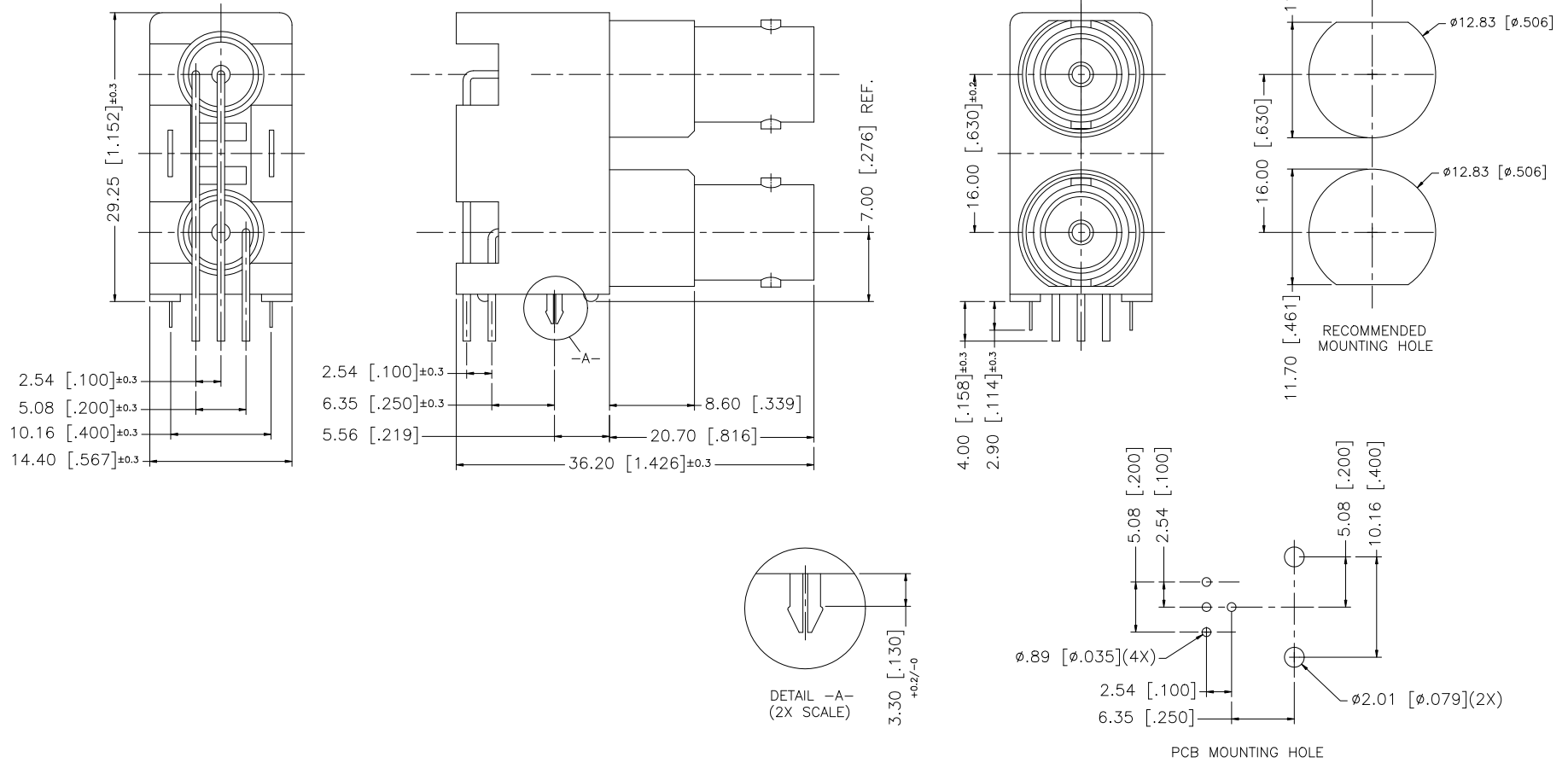

QTY	FINISH	MATERIAL	DESCRIPTION
1	NICKEL	ZINC DIE CAST	BODY
1	NATURAL	POLY PRO	INSULATOR
1	BRT. TIN	PHOS. BRONZE	CONTACT PIN
1	RED	PBT	HOUSING
1	BRT. TIN	COPPER	POST
1	BRT. TIN	COPPER	POST
1	BRT. TIN	BRASS	MOUNTING POST

UNLESS OTHERWISE SPECIFIED DIMENSIONS ARE IN MILLIMETERS. DIMENSIONS IN [] ARE IN INCHES AND FOR CUSTOMER REFERENCE ONLY.

UNLESS OTHERWISE SPECIFIED TOLERANCES FOR MILLIMETERS ARE:
0.5 - 8mm ± 0.20mm
8 - 30mm ± 0.40mm
30 - 120mm ± 0.50mm

UNLESS OTHERWISE SPECIFIED TOLERANCES FOR INCHES ARE:
.020 - .315 = ± 0.007"
.315 - 1.180 = ± 0.015"
1.180 - 4.724 = ± 0.020"

DO NOT SCALE DRAWING

APPROVALS	DATE
DRAWN G.R.S.	12/11/07
CHECKED	
ISSUED	
SHEET 1 OF 1	
CAD FILE C:/112/112705.DWG	

PART DESCRIPTION			
Amphenol Connex			
DUAL PORT BNC R/A PCB MOUNT RECEPTACLE - BLACK 50ohm			
PART NO.			
112705			
DWG. NO.	REV.	SIZE	SCALE
112705.DWG	A	A	NA